

# Tape & Pins

from Österleden road to Äckregårdsvägen road



ETTORE CONSOLAZIONE | rilievo, 1997

**THE TAPE** accompanies the entrance by car to the city of Varberg in a multifaceted way: it emerges from the ground, hides behind the trees, crosses them, jumps from one side of the road to the other, flies over and disappears again under the ground.

It is a building conceived as an **articulated line** in space, both in plan and in section, inhabited by a **traditional residential typology** revisited in a contemporary key such as the terraced single-family villa on two floors.

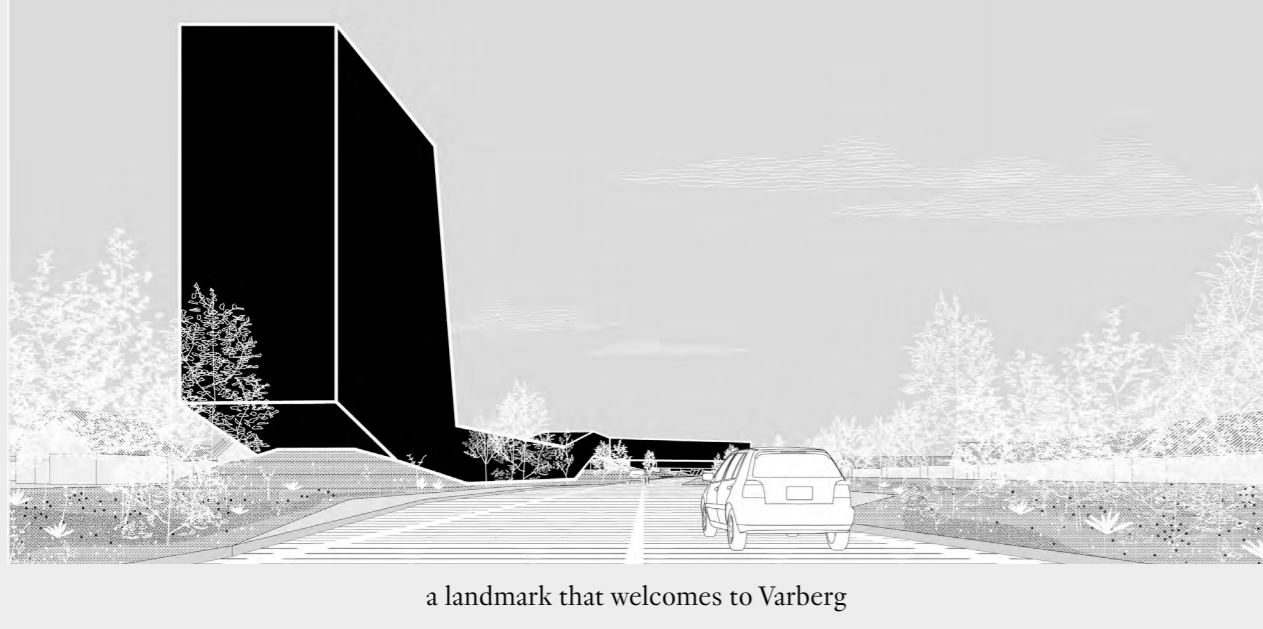

a landmark that welcomes to Varberg

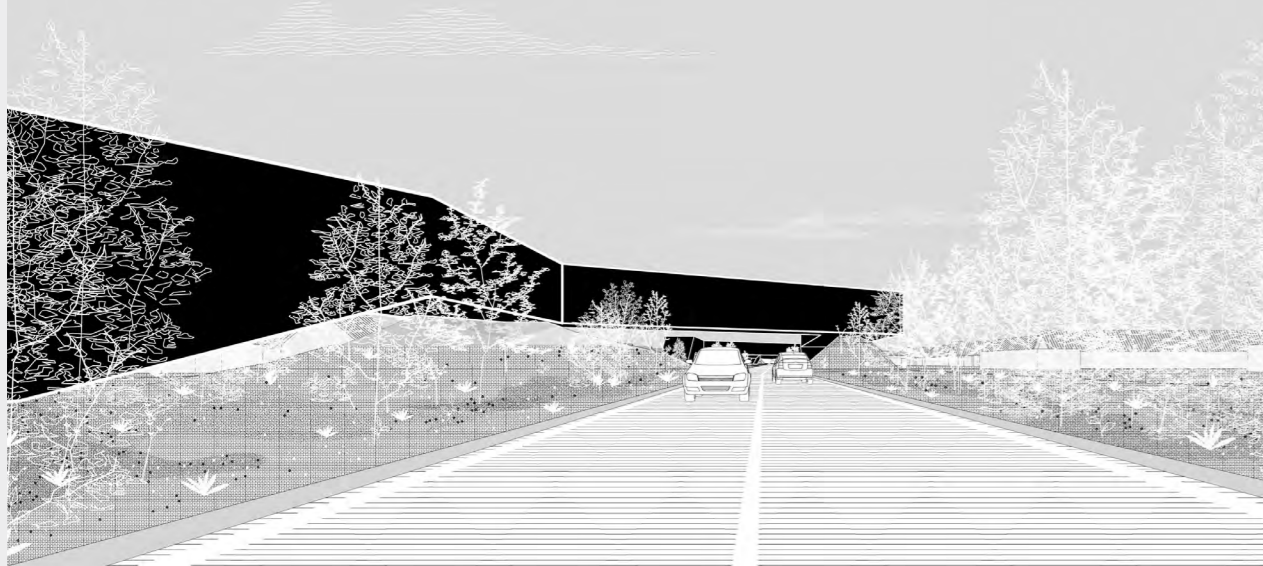

the building winds up the road like a ribbon...

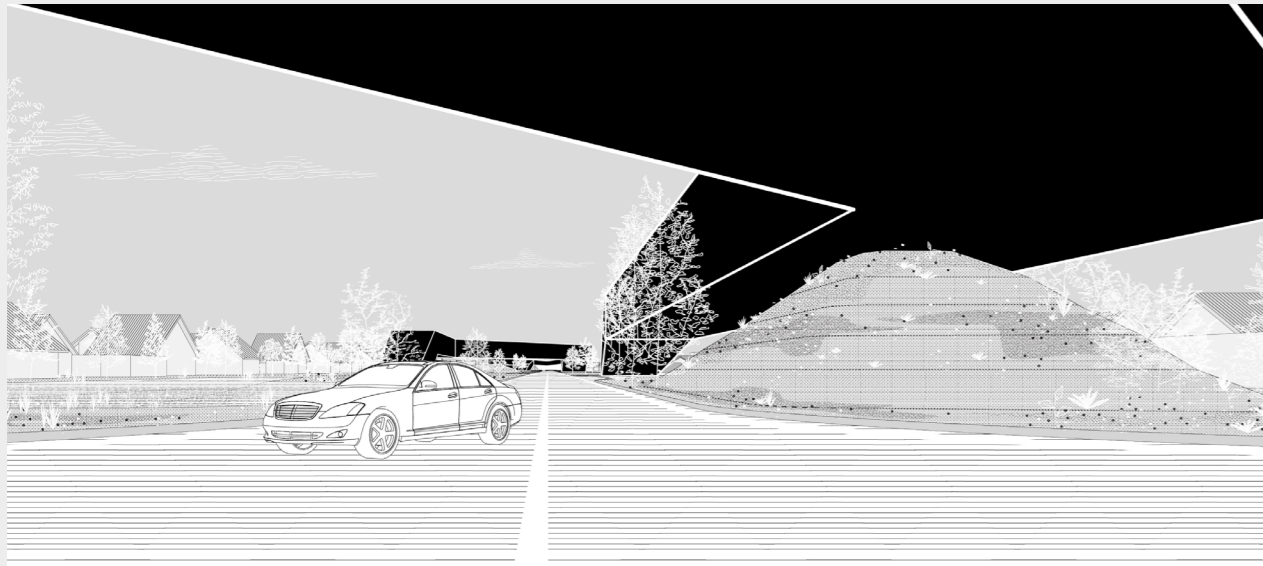

...it flies over the road and crosses it...

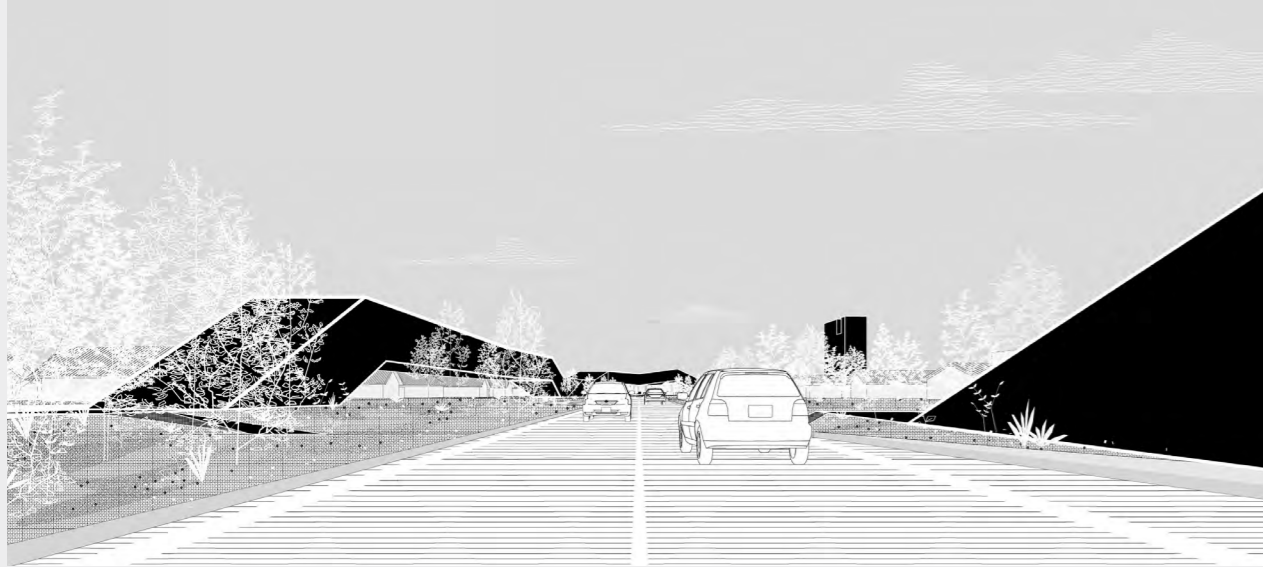

...it appears and disappears outlining the landscape

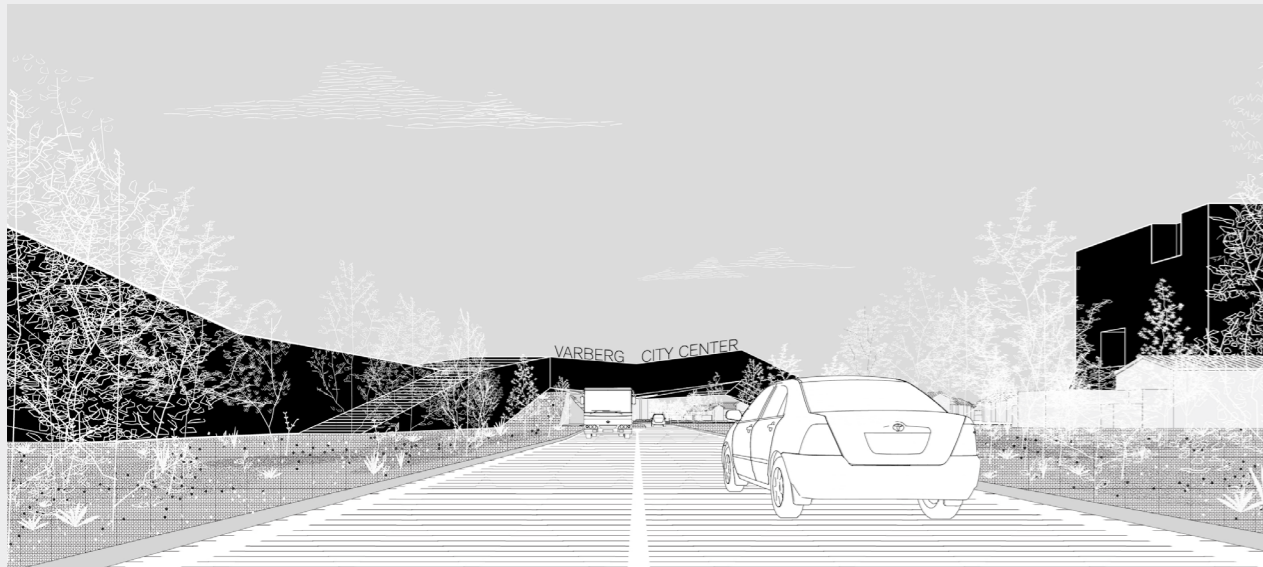

until the "Varberg City Center" marks the entrance to the city

The gallery that distributes each house is a **hybrid and domestic promenade**: the covered public cycle-pedestrian path mixes with the entrances to private residences and with bubbles of semi-private space, marked by small lantern-storage, which each inhabitant can colonize by expanding his home to the outside. At rhythmic intervals the residential curtain is interrupted and offers glimpses of the landscape

at a new elevated level, rapid vertical connections with the park below (stairs, ramps and elevators) near public transports, "district" functions as small shops or jolly rooms which can host workshops and activities for the community, in order to recreate a **heterogeneous cityscape** of ground floors typical of city centers.

**50%**  
housing  
private spaces

**8%**  
open-air private  
spaces

**26%**  
open-air  
semi-private spaces

**16%**  
public spaces

In the junctions of the building, where the Tape physically interconnects with the city paths, there are some "urban" functions of larger dimensions (such as the gym, offices, cinema) which, due to their strategic position, attract people from the nearby districts, helping to see the Tape as a strong **identifying attractor**. Each activity that finds space in the building - from housing to shops - is conceived as an **autonomous wooden construction** that

rests on an imposing **bidirectional reinforced concrete floor** covering large spans and in which engineering plant backbones run. If at the easternmost end this inhabited strip rises and takes the form of a landmark tower towards the landscape, at the other extreme towards the center of Varberg, the Tape gains mass and, bypassing the Trädlyckevägen with a plate dotted with patios, marks the successful entry into the city.

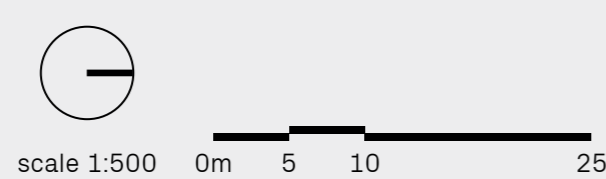

The project is presented following the Trädlyckevägen road entering the city. This board (02) goes from the intersection with Österleden road to the intersection with Äckregårdsvägen road

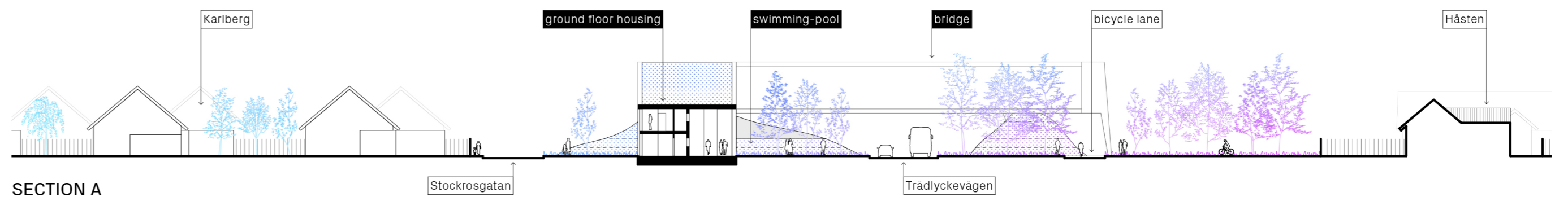

SECTION A

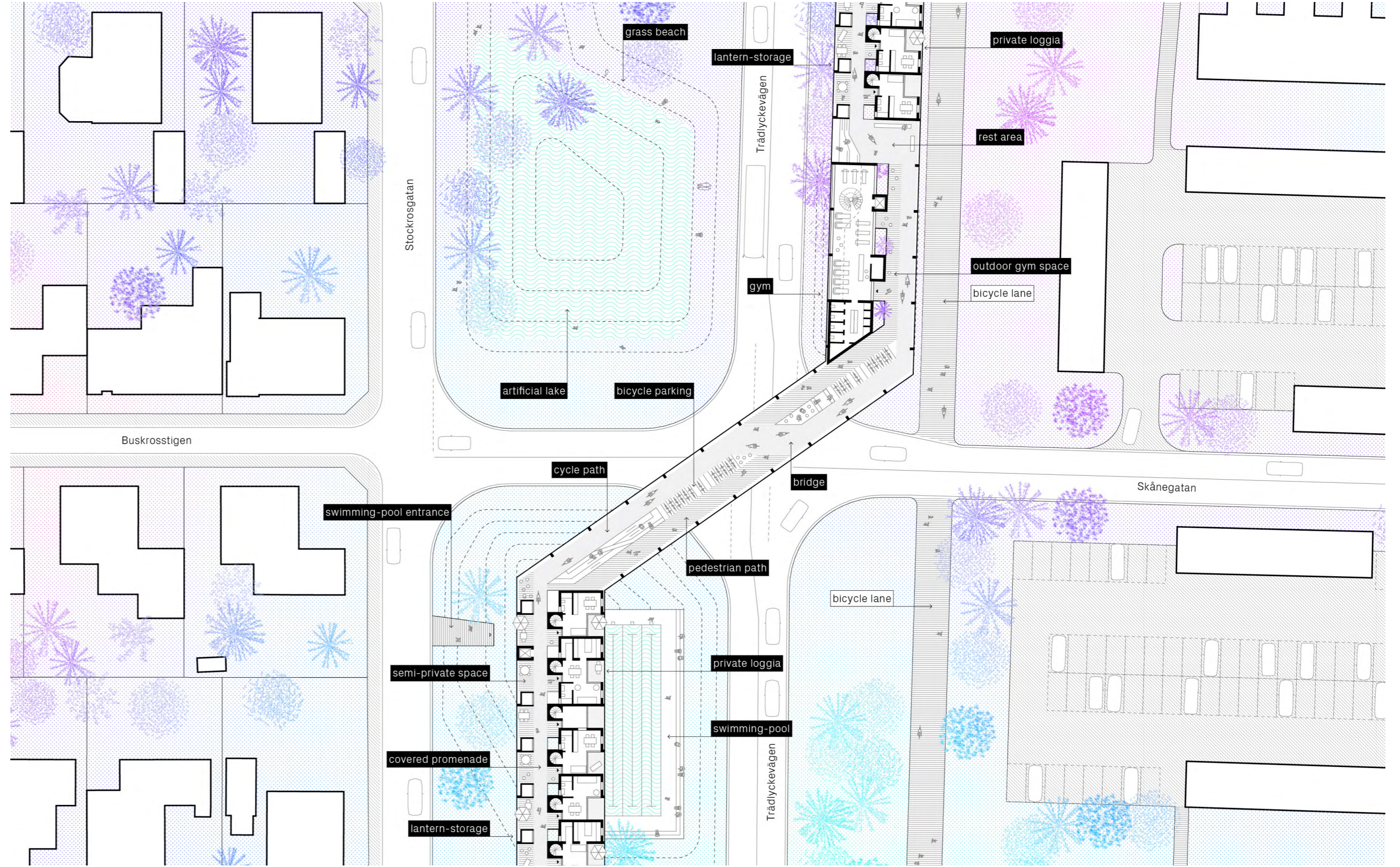

THE TAPE | main floor (housing, urban functions and bridge)

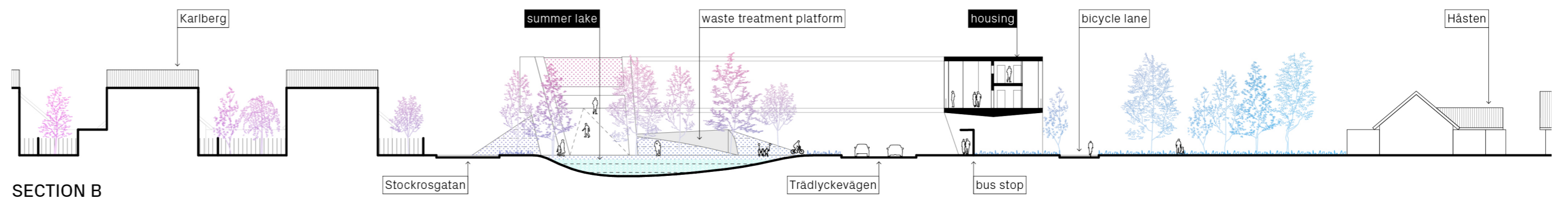

SECTION B

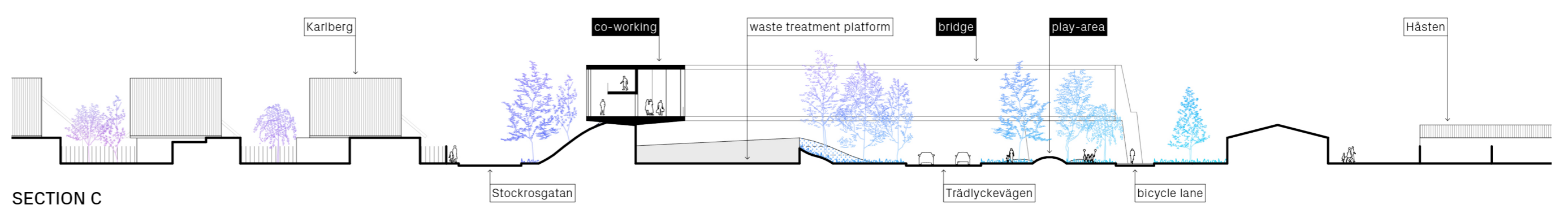

SECTION C

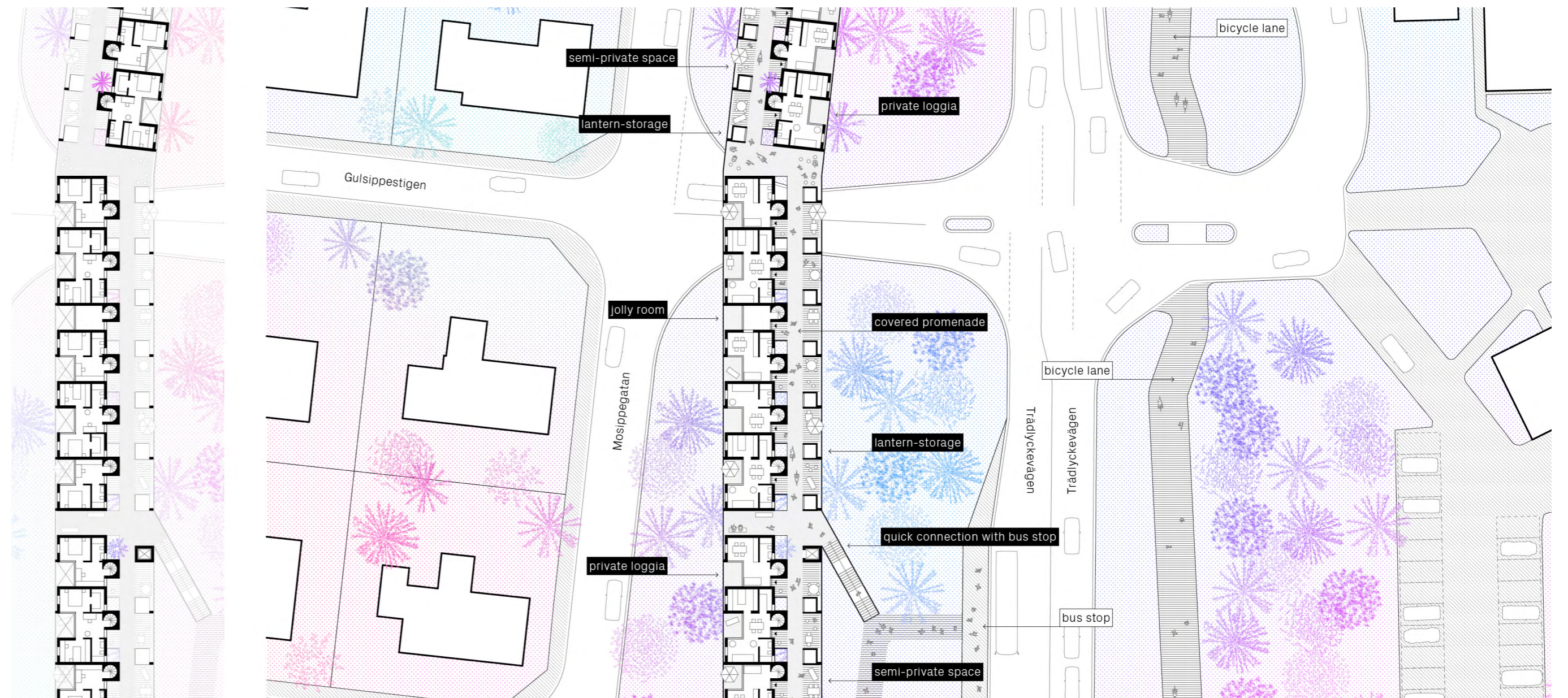

THE TAPE | left, upper floor - right, main floor (housing and neighborhood functions)

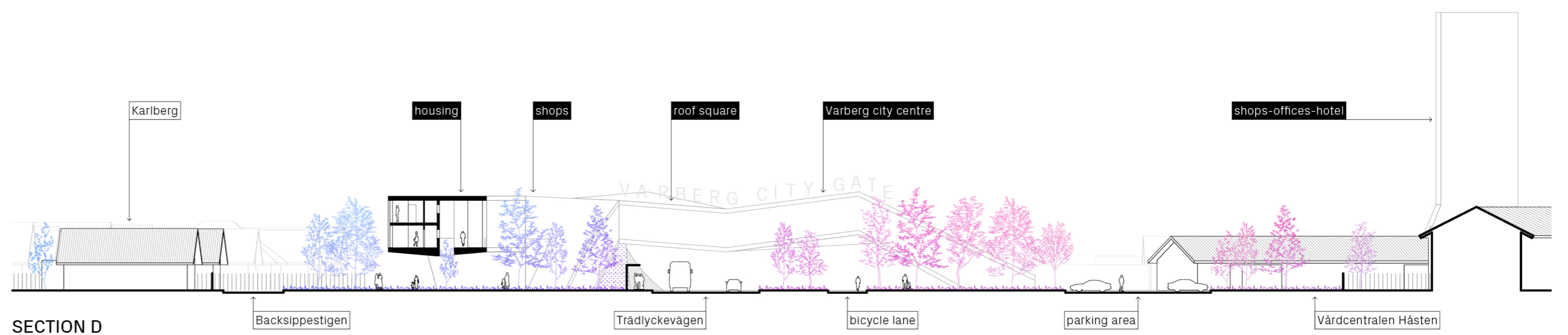

SECTION D